

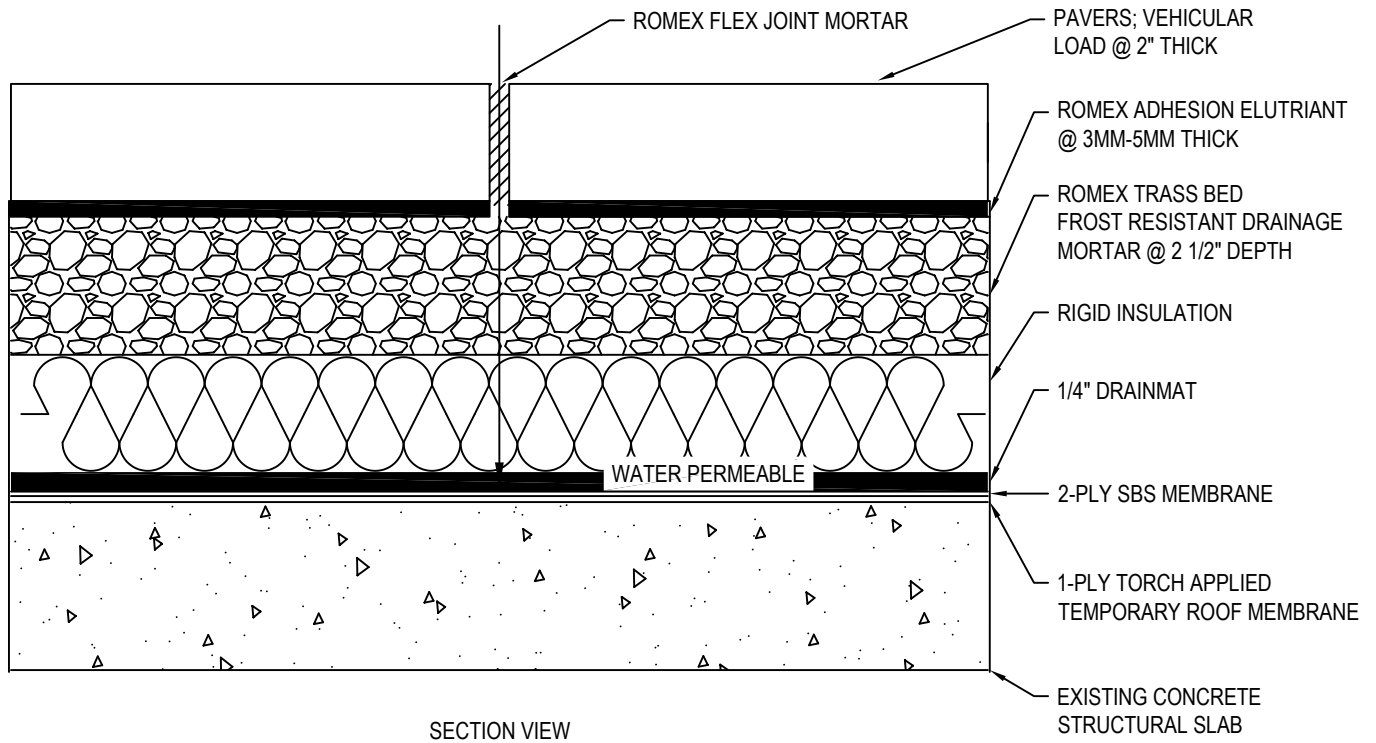

ROMEX NORTH AMERICA
260 RIVERSIDE DRIVE
NORTH VANCOUVER, BC V7H 2M2
PHONE: (604) 913-1579
www.romexcanada.com



ROMEX® - ADHESION ELUTRIANT:

MIXING: TO ACHIEVE A CONSISTENCY THAT IS PLASTIC AND CAN BE SPREAD, POUR 8.5 LITRES OF COOL, CLEAN WATER INTO A CONTAINER. THEN ADD 25KG OF ROMEX® - ADHESION ELUTRIANT AND STIR FOR 3 MINUTES. AFTER 3 MINUTES OF MATURING TIME STIR THROUGH AGAIN BRIEFLY. ALWAYS USE THE ENTIRE CONTAINER.

APPLICATION: APPLIED TO THE SLAB UNDERSIDE WITH A LAYER THICKNESS OF APPROX. 3-5MM OR DIP THE SLAB 2-3CM DEEP INTO THE TUB OF ROMEX® - ADHESION ELUTRIANT.

STORAGE LIFE: 6 MONTHS OF STORAGE LIFE (DRY IN ORIGINAL, SEALED SACK).

ROMEX® - TRASS BED

MIXING: MIX ROMEX® - TRASS BED COMPOUND IN A RATIO OF 1 TO 4 WITH FILLER MATERIAL (I.E ROLLED GRIT / GRAVEL) 4-8MM SO THAT IT IS EARTH DAMP, MIXING TIME 2-3 MINUTES. WATER REQUIREMENTS APPROX 9% (3.6-3.8 LITRES) OF COOL, CLEAN WATER PER 40 KGS OF READY TO USE MIXTURE. IMPORTANT TO ADD WATER TO THE MIXER FIRST, THEN THE MORTAR.

APPLICATION: NATURAL PAVING STONES SHOULD BE 3-6CM DEPENDING ON TYPE OF STONE AND EXPECTED LOADS. WHEN FILLING THE JOINTS, AT LEAST 3 CM JOINT DEPTH FROM THE TOP OF THE STONE IS REQUIRED, IN CASE OF TRAFFIC LOADS AT LEAST 2/3 OF THE HEIGHT. NATURAL AND CONCRETE STONE SLABS SHOULD BE TREATED WITH ROMEX® - ADHESION ELUTRIANT BEFORE LAYING.

STORAGE LIFE: 6 MONTHS OF STORAGE LIFE (DRY IN ORIGINAL, SEALED SACK).

NOTES:

1. INSTALLATION TO BE COMPLETED IN ACCORDANCE WITH MANUFACTURER'S SPECIFICATIONS.
2. DO NOT SCALE DRAWING.
3. THIS DRAWING IS INTENDED FOR USE BY ARCHITECTS, ENGINEERS, CONTRACTORS, CONSULTANTS AND DESIGN PROFESSIONALS FOR PLANNING PURPOSES ONLY. THIS DRAWING MAY NOT BE USED FOR CONSTRUCTION.
4. ALL INFORMATION CONTAINED HEREIN WAS CURRENT AT THE TIME OF DEVELOPMENT BUT MUST BE REVIEWED AND APPROVED BY THE PRODUCT MANUFACTURER TO BE CONSIDERED ACCURATE.
5. CONTRACTOR'S NOTE: FOR PRODUCT AND COMPANY INFORMATION VISIT www.CADdetails.com/info AND ENTER REFERENCE NUMBER 5315-004

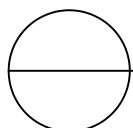

ROMEX® RSG PERMEABLE PAVING SYSTEM

ON INSULATED ROOF - VEHICLE LOADING